

# REPAIR PARTS

## 5 H.P. TILLER--MODEL NO. D5219AR

From: Nancy e AYP

### MAIN FRAME

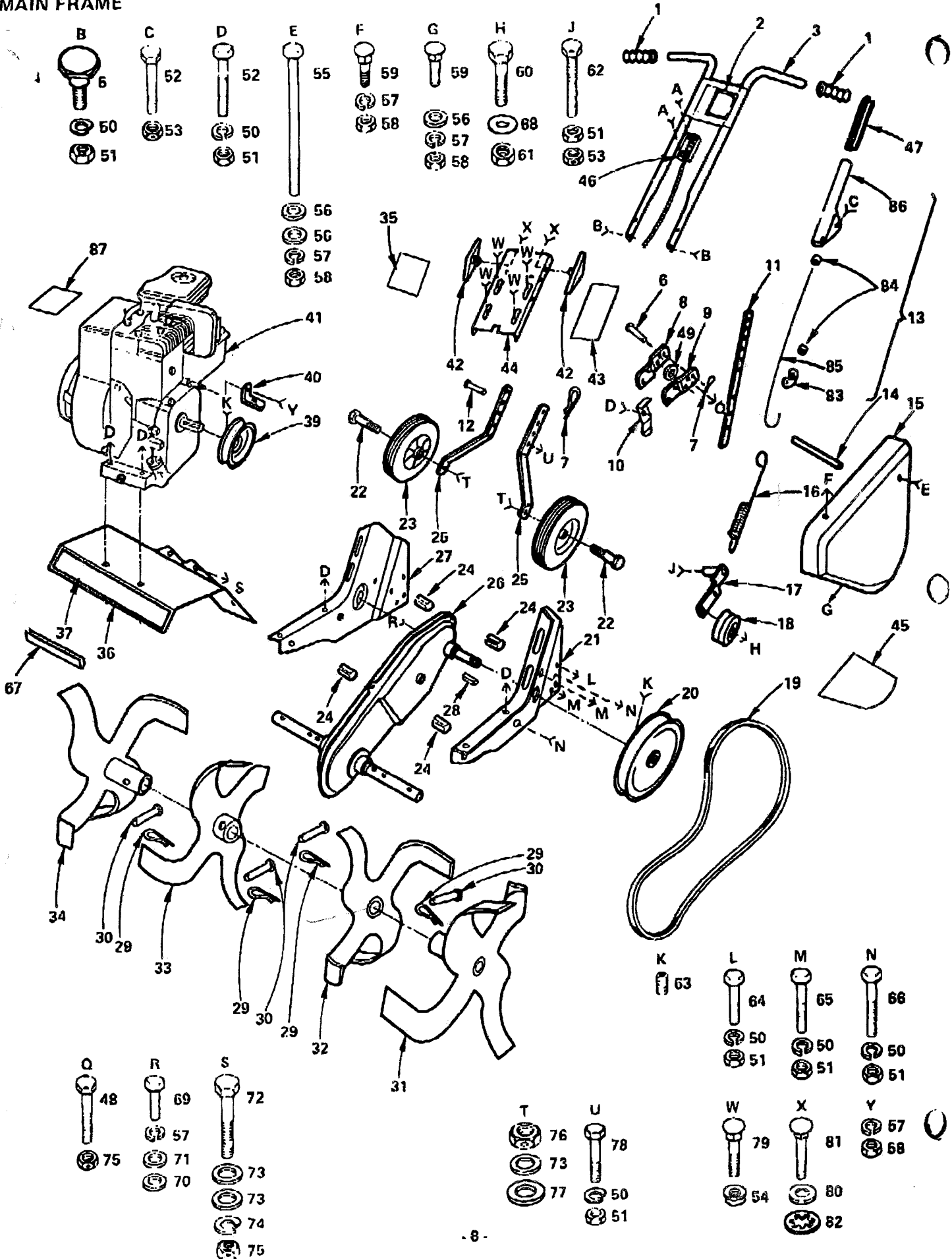

**5 H.P. TILLER--MODEL NO. D5219AR**

**MAIN FRAME**

| KEY NO. | PART NO. | DESCRIPTION  | KEY NO. | PART NO. | DESCRIPTION   |
|---------|----------|--|---------|----------|---|
| 1       | 9266R    | Handle Grip  | 47      | 8206H    | Handle Grip   |
| 2       | 928J     | Decal - Roper  | 48      | 3342P    | Hex Bolt 3/8 - 24 x 1 - 1/4 Gr. 5                         |
| 3       | 674A6B   | Handle Weldment  | 49      | 635J     | Washer  |
| 4       | 5535P    | Screw, Slotted Pan Hd. Tap Type 1, No. 10 - 24 x 5/8       | 50      | 1003P    | *Lockwasher 5/16  |
| 5       | 471J     | Bolt, Hex Hd. Shoulder 5/16 x 3/4                          | 51      | 604P     | *Hex Nut 5/16 - 18  |
| 6       | 326J     | Drilled Rivet  | 52      | 3013P    | *Hex Bolt 5/16 - 18 x 1 - 1/2                             |
| 7       | 4921H    | Retainer Spring  | 53      | 1685H    | Gripco Centerlock Nut 5/16 - 18                           |
| 8       | 1952J    | Stake Support - R.H.                                       | 54      | 571P     | Flanged Nut 5/16 - 18                                     |
| 9       | 1951J    | Stake Support - L.H.                                       | 55      | 3338P    | Hex Bolt 1/4 - 20 x 5                                     |
| 10      | 326J     | Stake Spring   | 56      | 1506P    | *Washer 9/32 x 5/8 x 16 Ga.                               |
| 11      | 9554R    | Depth Stake  | 57      | 1002P    | *Lockwasher 1/4   |
| 12      | 9194R    | Drilled Rivet  | 58      | 503P     | *Hex Nut 1/4 - 20   |
| 13      | 674A71   | Clutch Control Assembly (Inc. Key No's. 83, 84, 85 and 86) | 59      | 10P      | *Sq. Neck Carriage Bolt 1/4 - 20 x 1/2                    |
| 14      | 9271R    | Split Spacer   | 60      | 3026P    | *Hex Bolt 3/8 - 16 x 1 - 3/8                              |
| 15      | 9054R    | Belt Guard   | 61      | 608P     | *Hex Jam Nut 3/8 - 16                                     |
| 16      | 9241R    | Spring   | 62      | 3343P    | Hex Bolt 5/16 - 18 x 2 Full Thd.                          |
| 17      | 674A30   | Idler Arm Weldment   | 63      | 4537P    | Hex Forged Socket Headless Set Screw C.P. 5/16 - 18 x 3/8 |
| 18      | 310J     | Idler Pulley   | 64      | 3010P    | *Hex Bolt 5/16 - 18 x 3/4                                 |
| 19      | 9180R    | V-Belt   | 65      | 3012P    | *Hex Bolt 5/16 - 18 x 1 - 1/4                             |
| 20      | 9175R    | Transmission Sheave  | 66      | 3353P    | *Hex Bolt 5/16 - 18 x 2 - 1/2                             |
| 21      | 1948J    | Engine Bracket - L.H.                                      | 67      | 1084J    | Vinyl Guard Strip   |
| 22      | 4898H    | Shoulder Bolt  | 68      | 1513P    | Washer 13/32 x 13/16 x 16 Ga.                             |
| 23      | 9187R    | Wheel  | 69      | 3345P    | Hex Bolt 1/4 - 28 x 3/4 Gr. 5                             |
| 24      | 9173R    | Split Spacer   | 70      | 1584P    | Washer 9/32 x 7/8 x 12 Ga.                                |
| 25      | 9190R    | Wheel Bracket  | 71      | 1685P    | Washer 9/32 x 1 - 1/4 x 16 Ga.                            |
| 26      | 674A21   | Transmission   | 72      | 3347P    | *Hex Bolt 3/8 - 24 x 3 Gr. 5                              |
| 27      | 1949J    | Engine Bracket - R.H.                                      | 73      | 1557P    | *Washer 13/32 x 13/16 x 11 Ga.                            |
| 28      | 2649M    | Square Key   | 74      | 1004P    | *Lockwasher 3/8   |
| 29      | 3146R    | Retainer Spring  | 75      | 7810H    | Gripco Nut 3/8 - 24                                       |
| 30      | 4929H    | Drilled Pan Hd. Rivet                                      | 76      | 514P     | Nylock Nut 3/8 - 16                                       |
| 31      | 674A40   | Tine Weldment Outer - L.H.                                 | 77      | 1545P    | *Washer 17/32 x 1 x 16 Ga.                                |
| 32      | 674A38   | Tine Weldment Inner - L.H.                                 | 78      | 3011P    | *Hex Bolt 5/16 - 18 x 1                                   |
| 33      | 674A39   | Tine Weldment Inner - R.H.                                 | 79      | 16P      | *Sq. Neck Carriage Bolt 5/16 - 18 x 3/4                   |
| 34      | 674A41   | Tine Weldment Outer - R.H.                                 | 80      | 1511P    | Washer 3/8 x 7/8 x 14 Ga.                                 |
| 35      | 1167J    | Decal - 5  | 81      | 62P      | *Sq. Neck Carriage Bolt Sht. Shoulder 5/16 - 18 x 1 - 1/4 |
| 36      | 9056R    | Tine Shield  | 82      | 1410P    | Hvy. Internal Lockwasher Type A 5/16                      |
| 37      | 432J     | Decal (on Tine Shield)                                     | 83      | 9548R    | Clutch Adjusting Clip                                     |
| 39      | 9177R    | Engine Sheave  | 84      | 9549R    | Aluminum Stop   |
| 40      | 9185R    | Belt Guard Bracket   | 85      | 334J     | Cable - 29"   |
| 41      | 130202   | Engine, 5 H.P. Briggs & Stratton Type No. 0830-01          | 86      | 336J     | Clutch Lever  |
| 42      | 9210R    | Knob   | 87      | 9692R    | Decal - Engine  |
| 43      | 9225R    | Decal - Instruction  | --      | 2069J    | Owners Manual   |
| 44      | 9209R    | Handle Panel   |         |          |   |
| 45      | 9618R    | Decal - Stripes  |         |          |   |
| 46      | 340J     | Throttle Control   |         |          |   |

\*STANDARD HARDWARE--PURCHASE LOCALLY