

# SERVICE KIT

## 753-0534

CODE: RT-109  
DATE: September 14, 1992  
SUBJECT: Engineering Changes -  
Model 430 Tiller

Install service kit 753-0534 if a replacement chain case part number 784-0150 is need. Parts included in this kit are shown in the illustration below. Keep this sheet for ordering replacement parts.

**Note:** If your tiller is a model 212A430, the chain case only may be replaced. You do not need to change the other parts on the tiller, as your unit is already equipped with these parts.

After installing the new parts on your unit, discard the original parts which have been replaced, and attach and adjust the new clutch cable as described in this sheet.

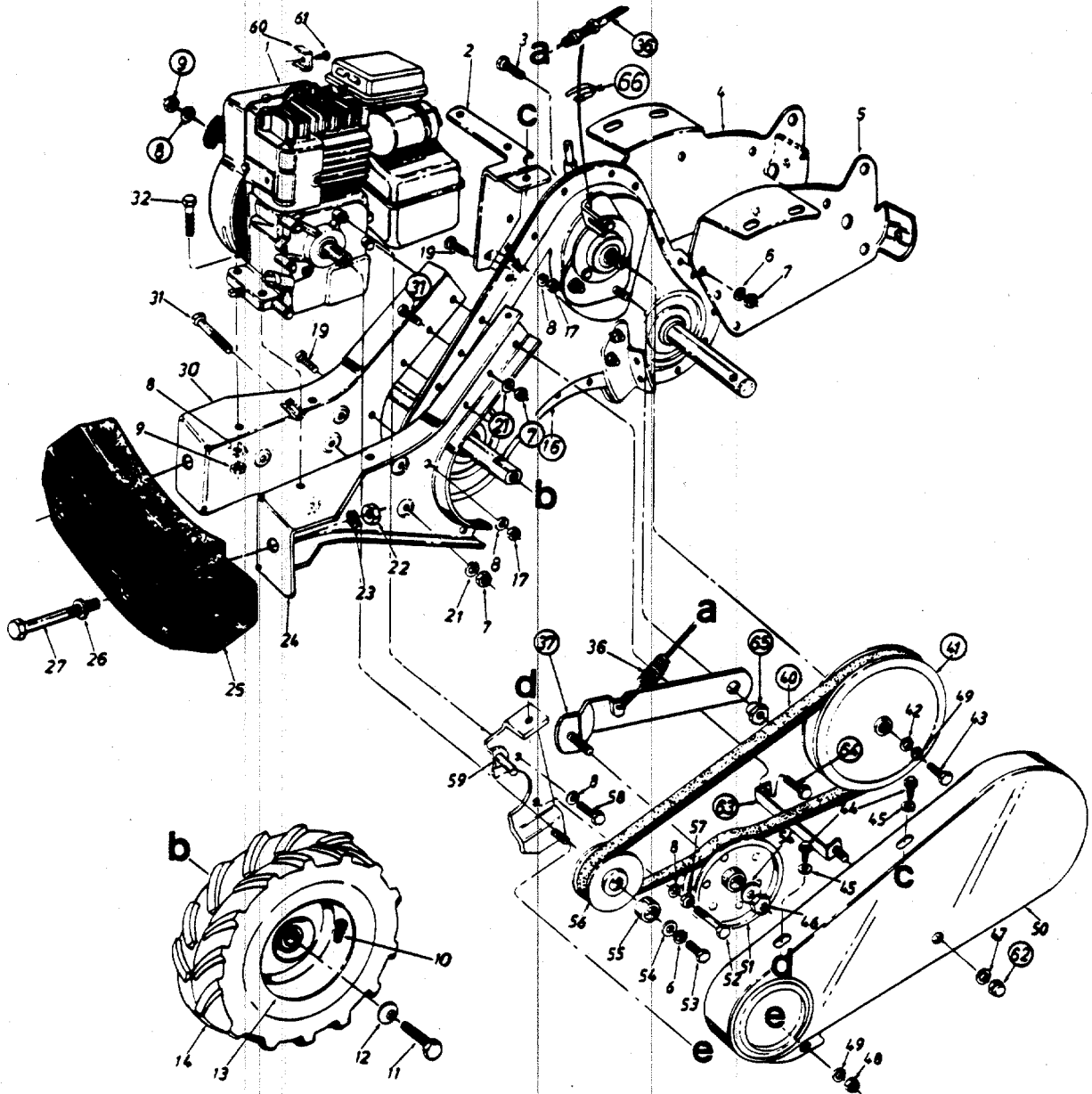

**KIT 753-0534 CONSISTS OF:**

**NOTE: Parts List of Changes to Page 17 of Owner's Guide**

REF. NO.	PART. NO.	DESCRIPTION
7	712-0798	Hex Nut 3/8-16 Thd.*
8	736-0119	L-Wash 5/16" I.D.*
9	712-0267	Hex Nut 5/16-18 Thd.*
15	omit	
16	686-0030	Chain Case Comp.
21	736-0217	L-Wash. 3/8" I.D.--H.D.
31	710-0216	Hex Bolt 3/8-16 x .75" Lg.
33	omit	
34	omit	
35	omit	
36	746-0908	Clutch Control Cable 46" Lg.
37	686-0026	Idler Bracket Ass'y
38	omit	
39	omit	
40	754-0267	"V" Belt
41	756-0634	FI-Pulley 8" O.D.
47	736-3020	FI- Wash. .266" I.D. x .625"
62	712-0392	Hex Cap Nut 1/4-28 Thd.
63	686-0027	Belt Cover Bracket Ass'y
64	710-0376	Hex Bolt 5/16-18 x 1" Lg. (Gr. 5)
65	738-0876	Shld. Nut
66	725-0157	Cable Tie

**NOTE: Parts List of Changes to Page 18 Of Owner's Guide**

REF. NO.	REF. NO.	DESCRIPTION
55	786-0065	Gear Positioner Bracket
-	686-0030	Chain Case Comp.

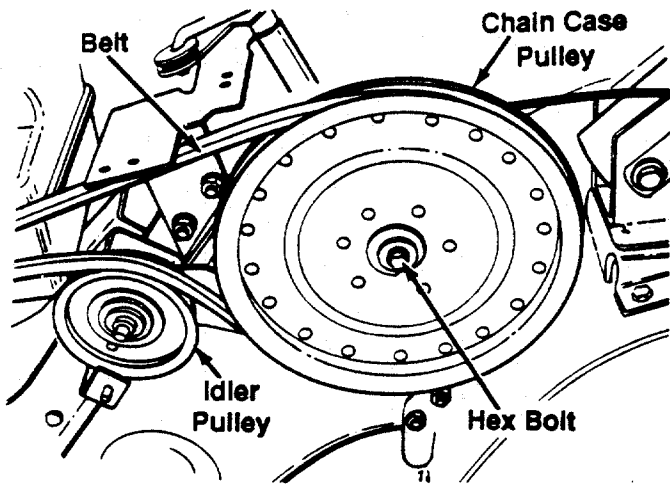

FIGURE A

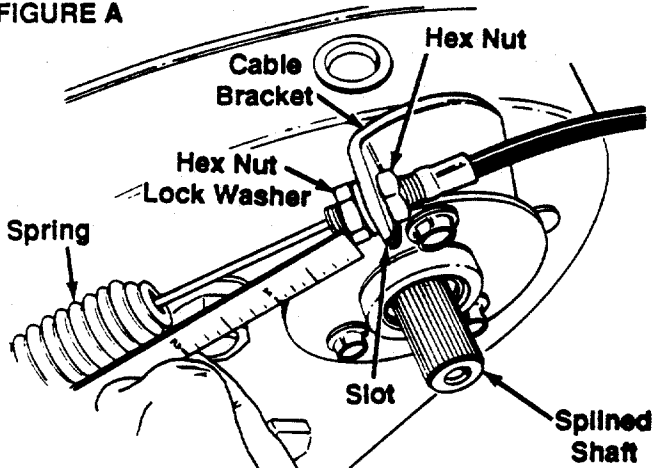

FIGURE B

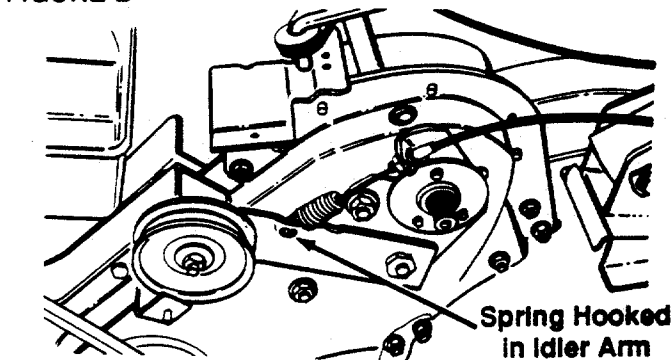

FIGURE C

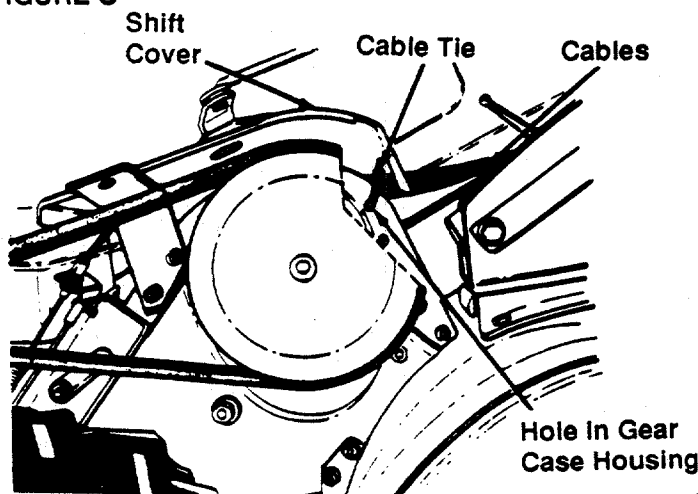

FIGURE D

Assemble and adjust the clutch cable as follows.

1. The drive cable is the cable which has a spring on one end. Remove one hex nut from the end of the drive cable casing. Thread the other hex nut all the way up the threaded casing.
2. Remove the center bolt (and washers) from the chain case pulley (large pulley at the rear of the tiller.) Remove the pulley from the splined shaft. See figure A.
3. There is a cable bracket which has a hole with a slot in it, located approximately 2 inches above the splined shaft. Pull the spring, the first nut and the lock washer all the way to the end of the cable. Slip the cable through the slot in the cable bracket, then slide the cable casing through the hole.
4. Thread the lock washer and hex nut back onto the cable casing so approximately 1/8" of threads show (only a couple threads). Thread the hex nut on the other side of the cable bracket against the bracket, and tighten securely. See figure B.
5. Hook the spring into the hole in the idler arm bracket. See figure C.
6. Slide the chain case pulley back onto the splined shaft. Secure with hardware removed in step B. Place belt around the chain case pulley. Route the belt over top of the idler pulley. Refer to figure A.
7. Secure the drive cable and the throttle control cable to the top of the gear case housing (underneath the shift cover) using the cable tie provided, keeping the cables away from the pulley. See figure D.
8. Replace the belt cover, and secure with hardware removed. (The hex nut in the middle of the belt cover has been replaced by a hex cap nut.)

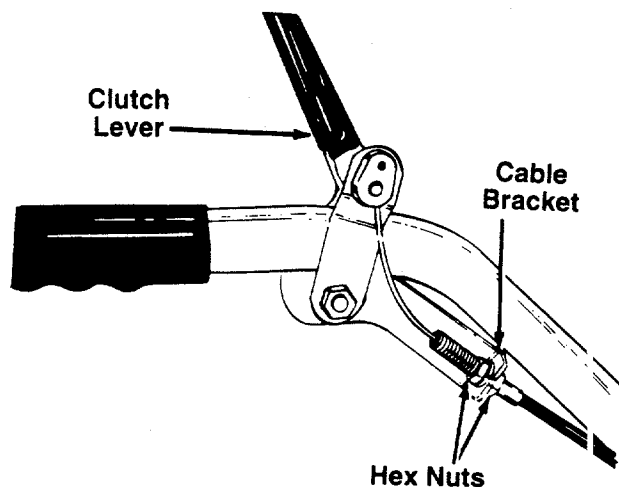

FIGURE E

9. Check the clutch adjustment as follows.

**IMPORTANT:** Service the engine with oil and gasoline before checking this adjustment. Refer to the separate engine manual packed with your tiller.

- a. Position the tiller so the front counterweight is against a solid object, such as a wall. With the gear selection lever in NEUTRAL, start the engine.
- b. Standing on the right side of the tiller, examine the belt (inside the belt cover). It should not be turning.

If the belt turns with the unit in neutral, adjust by moving the hex nut below the cable bracket down a few turns. See figure E. Tighten the upper hex nut against the bracket.

- c. Now move the shift lever to FORWARD (Wheels Forward) position. Carefully engage the clutch by squeezing the clutch lever against the left handle. The wheels should spin.

If the wheels do not spin with the unit in forward, adjust by moving the hex nut which is above the cable bracket up a few turns. Tighten the bottom hex nut against the bracket.

Recheck both adjustments, and readjust as necessary.

**NOTE:** If you reach the point that additional adjustment is needed, remove the belt cover and move the hex nuts at the other end of the cable towards the end of the casing. Then readjust the hex nuts at the handle.