

SERVICE KIT

753-0598

[Replaces Part No. 618-0009]

CODE: T-114
DATE: March 18, 1994
SUBJECT: 2 Speed Transaxle
800 Series
Garden Tractor

The replacement transmission has been updated and requires a service kit.

1. Remove the shift knob and parking brake knob.
2. Remove shift cover from unit.
3. Remove the reverse safety switch assembly from the old shift cover and discard shift cover.
4. Install the reverse safety switch assembly to the new shift cover provided in the kit.

NOTE: Be careful not to damage the insulator nut when attaching the switch to the cover. This could result in a grounding out of the unit regardless of the shifter position.

5. Apply the label provided in the kit to the new shift cover.
6. Remove the old transmission from the unit.
7. Install the new shifter assembly provided as follows:
 - A. Place the "O" ring in the lower snout groove.
 - B. Check to make certain the "O" ring is properly positioned in the upper snout.

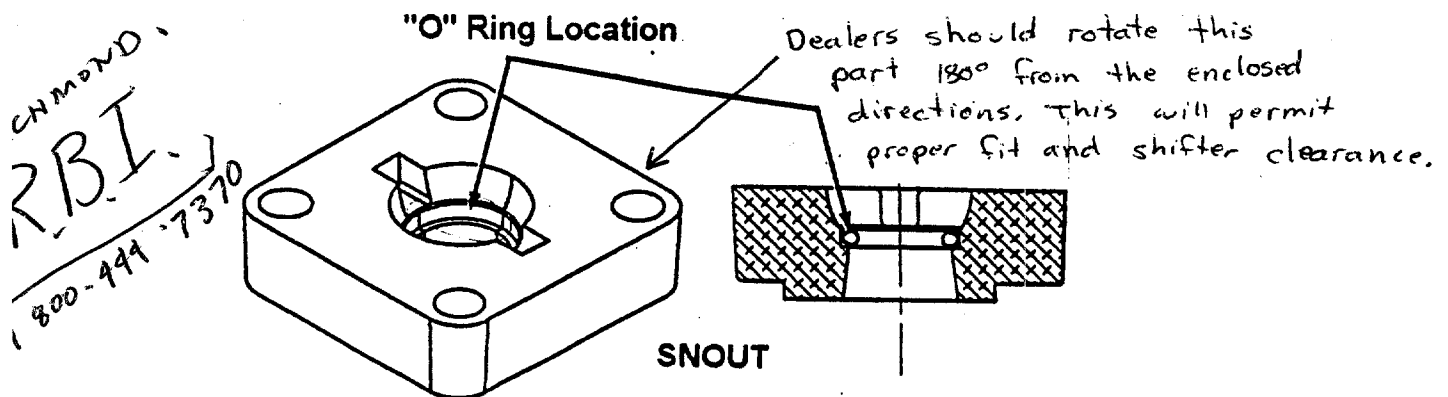

- C. Apply "Never Seize" to the ball on the shifter.
- D. Install the lower snout on the shifter. Make certain the "O" ring remains in position on both the upper and lower snout.

NOTE: The upper and lower snout will have a small gap between the surfaces caused by the "O" rings. This gap will be taken up when the shifter is secured to the upper housing.

Models 820 thru 829; 840 thru 849

753-0598

717-1158

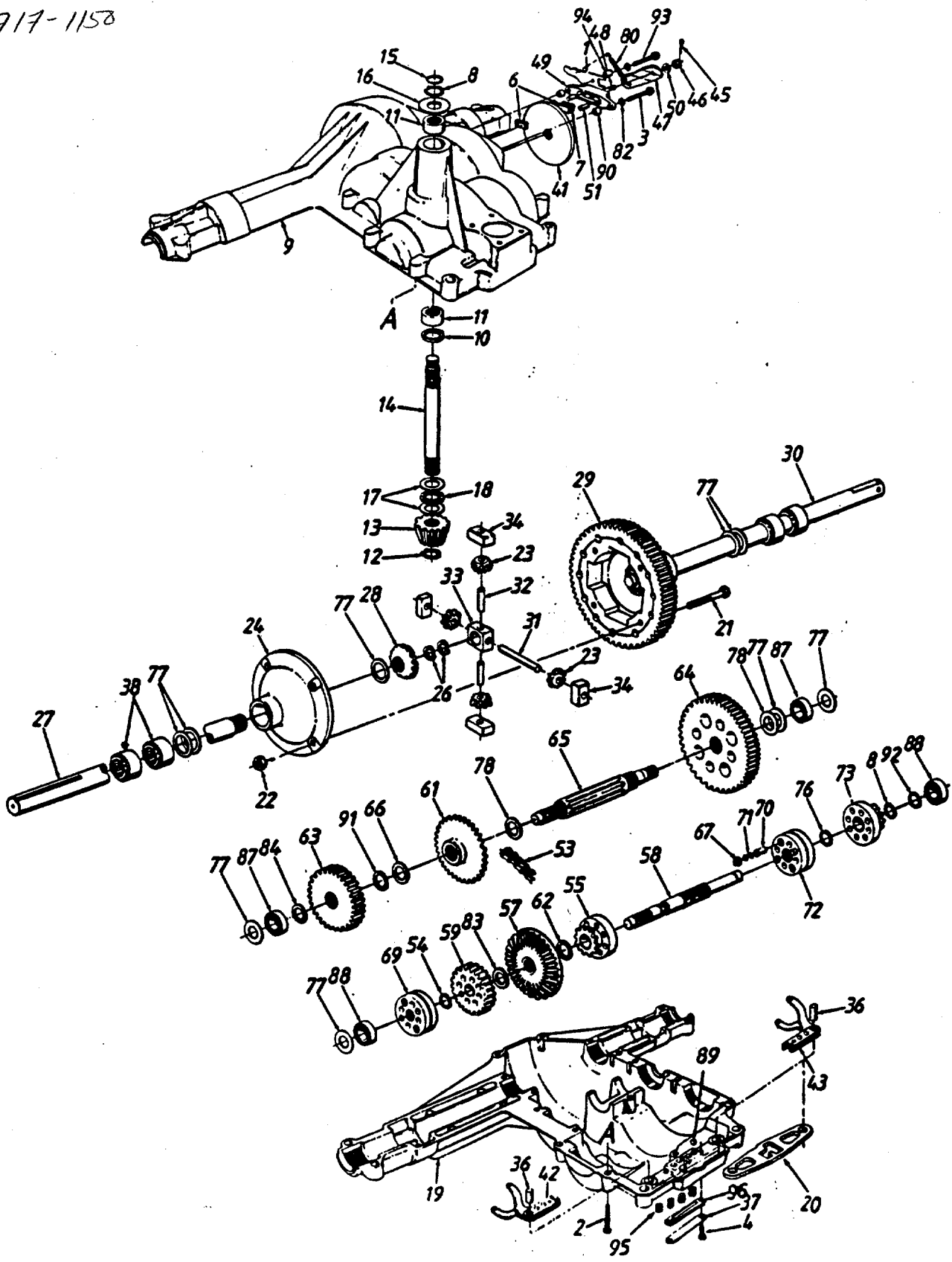

Models 820 thru 829; 840 thru 849

PARTS LIST FOR MODEL 618-0156 TRANSAXLE

F. I.	PART NO.	CODE	DESCRIPTION	REF. NO.	PART NO.	CODE	DESCRIPTION
	17434A	N	Brake Return Bracket	48	717-0796		Sq. Hd. Bolt 5/16-24 Thd.
	710-0809		Hex Bolt 1/4-20 x 1.25" Lg.	49	717-1179		Brake Yoke
	710-3201		Hex Bolt 1/4-20 x 1.5" Lg. (Gr. 5)	50	736-0371		Fl-Wash. 11/32" I.D. x 7/8" O.D.
	710-0599		Hex Wash. Tap Scr. 1/4-20 x .5" Lg.	51	741-0343		Brake Actuating Pin
	717-0678		Brake Puck	53	713-0326		#420 Chain 1/2 Pitch x 28 Links
	717-0682		Puck Plate	54	716-0133		Retainer Ring
	716-0171		Retainer Ring	55	717-1141		Reverse Sprocket Ass'y.
	619-0013		Upper Housing	57	717-1157		Bevel Gear 47T
	721-0253		Oil Seal	58	711-0860		Drive Shaft
	741-0525		Needle Brg. 5/8" I.D. x 7/8" O.D.	59	717-1174		Spur Gear Ass'y.
	716-0114		Snap Ring	61	717-1182		Sprocket 22T
	717-1133		Input Pinion 15T	62	736-0421		Fl-Wash. .81" I.D. x 1.18" O.D.
	717-1134		Input Shaft	63	717-1155		Spur Gear 31T
	732-0614		Wire Ring	64	717-1156		Spur Gear 45T
	736-0335		Thrust Washer 5/8" I.D.	65	717-1158		Output Shaft 9T
	736-0419		Thrust Washer	66	717-1172		Spacer
	741-0469		Thrust Bearing	67	718-0183		Shift Spring Plug
	717-1161		Lower Housing	69	717-1167B		Forward Shift Collar
	718-0258		Lockout Plate	70	717-1184		Drive Pin
	710-0151		Hex Bolt 3/8-24 x 2.0" Lg.*	71	732-0590A		Drive Spring
	712-3054		Hex L-Nut 3/8-24 Thd. (Gr. 5)	72	717-1168B		Creeper Shift Collar
	717-1120		Differential Gear 10T	73	717-1193		Creeper Collar Plate Ass'y.
	717-1147		Differential Housing Cover Ass'y.	76	736-0353		Fl-Wash. .65" I.D. x .97" O.D.
	716-0172		Retainer Ring	77	**		Fl-Wash. (See Below)
	717-1112		Axle R.H.	78	736-0424		Fl-Wash. 1.0" I.D. x 1.56" O.D.
	717-1119		Differential Gear 14T	80	732-0545		Ext. Spring 1.14" Lg.
	717-1159		Differential Bull Gear 60T	82	736-0329		L-Wash. 1/4" I.D.*
	717-1111		Axle L.H.	83	736-0349		Fl-Wash. 5/8" I.D. x 1.0" O.D.
	717-1173		Cross Shaft	84	736-0422		Fl-Wash. .68" x 1.12"
	717-1178		Cross Shaft—Special	87	741-0124		Ball Brg. .669" I.D.
	717-1180		Differential Pinion Block	88	741-0524		Ball Bearing
	717-1190		Differential Thrust Block	90	750-0555		Spacer .254" I.D. x .5" O.D.
	717-1138		Shift Pin	91	736-0333		Fl-Wash. .69" I.D. x 1.06" O.D.
	717-1139		Spring Plate	92	***		Fl-Wash. (See Below)
	741-1143		Axle Bearing Ass'y.	93	710-1225		Hex Wash Hd. Patch Bolt 1/4-20 x 2-1/4" Lg.
	717-1177		Brake Disc	94	750-0893		Spacer .256" I.D. x .75" O.D.
	717-1185		Shift Arm Ass'y.—R.H.	—	737-0148		Shell Darina Grease 14 oz. Tube (32 oz. Req'd.)
	717-1186		Shift Arm Ass'y.—L.H.				Detent Spring
	714-0111		Cotter Pin 3/32" Dia.	95	732-0496		Spring Plate Shim
	712-0335		Castle Nut 5/16-24 Thd.	96	717-1148		
	717-0700		Brake Actuating Arm				

** Ref. No. 77 736-0423 Fl-Wash. 1" I.D. x 1.56" O.D. x .010" Thk.
 736-0431 Fl-Wash. 1" I.D. x 1.56" O.D. x .015" Thk.
 736-0424 Fl-Wash. 1" I.D. x 1.56" O.D. x .020" Thk.
 736-0420 Fl-Wash. 1" I.D. x 1.56" O.D. x .040" Thk.

** Ref. No. 92 736-0349 Fl-Wash. 5/8" I.D. x 1.0" O.D. x .020" Thk.
 736-0336 Fl-Wash. 5/8" I.D. x 1.0" O.D. x .030" Thk.
 736-0337 Fl-Wash. 5/8" I.D. x 1.0" O.D. x .040" Thk.

- E. Install (4) screws through both snouts.
- F. Make certain both forks are lined up equally. The transmission MUST be in neutral position prior to shifter installation.
- G. Approaching the transmission from the front position with the shifter to the left, insert the shifter into the transmission. The shifter can only be installed in the transmission one way, which is left of the neutral position in the low range quadrant.
- H. Secure the shifter by tightening all four screws to 60-90 in. Lbs.
- I. Shifter must have free movement to the left and right for proper installation.

IF SHIFTER IS INSTALLED WRONG IT MAY INTERFERE W/ TRANS PULLEY

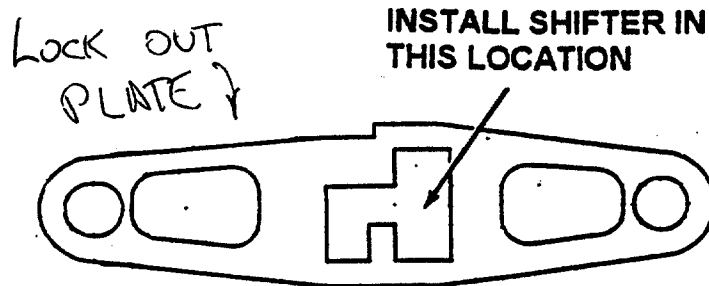

SHIFT QUADRANT LOCATED IN TRANSMISSION CASE ABOVE THE SHIFT FORKS

NOTE: THE SHIFT LEVER IN YOUR TRANSMISSION MAY APPEAR SLIGHTLY DIFFERENT THAN THE DRAWING.

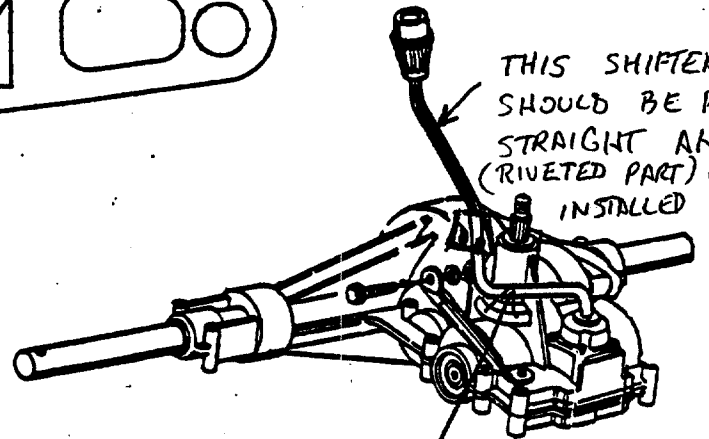

Install the new transmission in the unit.

Attach the Yellow kill wire to the reverse safety switch and secure the shift cover to the unit.

. Install the parking brake rod through the shift cover.

. Install the shift knob and parking brake knob.

. Test the transmission for proper shift pattern and operation. Test reverse kill switch feature.

E 753-0598 CONSISTS OF THE FOLLOWING:

PART NO.	DESCRIPTION
618-0166	Transmission
618-0155	Shifter
783-0246	Shift Cover 783-0245A
777-2548	Shift Cover Label 777-2548
710-0886	Screws (4)
718-0256	Snout
721-3033	"O" Ring
737-0290	Never Seize

W.O.P. SHIFT COVER FOR '93 783-0246
 W/777-2552 STY 6

- E. Install (4) screws through both snouts.
- F. Make certain both forks are lined up equally. The transmission **MUST** be in neutral position prior to shifter installation.
- G. Approaching the transmission from the front position with the shifter to the left, insert the shifter into the transmission. The shifter can only be installed in the transmission one way, which is left of the neutral position in the low range quadrant.
- H. Secure the shifter by tightening all four screws to 60-90 In. Lbs.
- I. Shifter must have free movement to the left and right for proper installation.

IF SHIFTER IS INSTALLED WRONG MAY INTERFERE w/ TRANS PULLEY

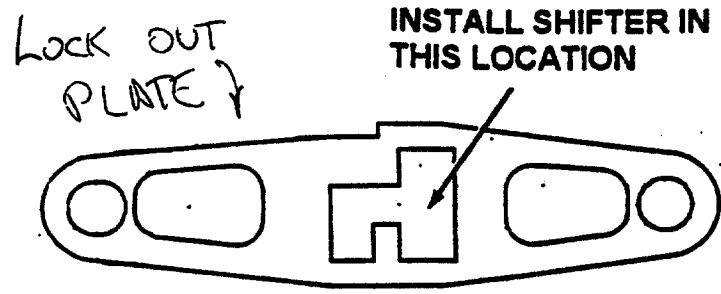

NOTE: THE SHIFT LEVER IN YOUR TRANSMISSION MAY APPEAR SLIGHTLY DIFFERENT THAN THE DRAWING.

SHIFT QUADRANT LOCATED IN TRANSMISSION CASE ABOVE THE SHIFT FORKS

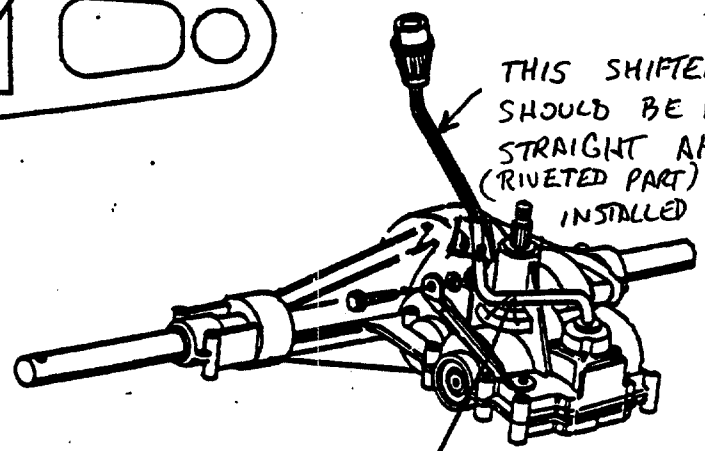

USE THIS SHEET FOR "FAXING" PURPOSES.

- 9. Install the unit.
- 1. Attach the Yellow kill wire to the reverse safety switch and secure the shift cover to the unit.
- 0. Install the parking brake rod through the shift cover.
- 1. Install the shift knob and parking brake knob.
- 2. Test the transmission for proper shift pattern and operation. Test reverse kill switch feature.

THE 753-0598 CONSISTS OF THE FOLLOWING:

QTY	PART NO.	DESCRIPTION
1	618-0166	Transmission
1	618-0155	Shifter
1	783-0245	Shift Cover 783-0245A →
1	777-2548	Shift Cover Label 777-2548
4	710-0886	Screws (4)
1	718-0256	Snout
1	721-3033	"O" Ring
1	737-0290	Never Seize