

# SERVICE KIT

## 753-0610

CODE: RT-121  
 DATE: OCTOBER 13, 1994  
 SUBJECT: CHAIN CASE ASS'Y. FOR  
 406 TILLER

SERVICE KIT 753-0610 REPLACES WHEEL CHAIN CASE ASS'Y. COMPLETE 784-0104A.

**NOTE:** Use 10 ounces of #00EP grease. Order Part No. 737-0223.

KIT 753-0610 CONSISTS OF:

PART NO	DESCRIPTION
686-0069	Wheel Chain Case Complete
770-8868K	Service Kit Sheet

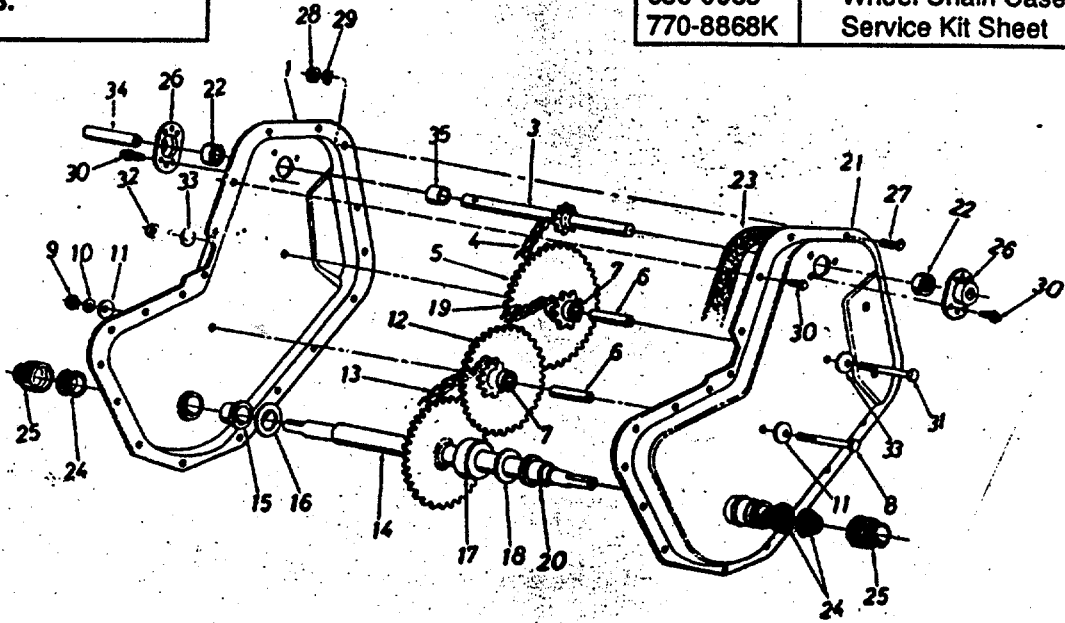

REF. NO.	PART NO.	CODE	DESCRIPTION	REF. NO.	PART NO.	CODE	DESCRIPTION
1	686-0066	N	Chain Case Half Ass'y.—R.H.	19	713-0267		#420 Chain 1/2" Pitch x 30
2	748-0154		Bearing 5/8" I.D. x .813" O.D. x 1.31" Lg.	20	741-0227		Links Endless
3	784-0136A		Input Shaft Ass'y.	21	15797		Flange Bearing
4	713-0325		Chain #35—3/8" Pitch x 44 Links	22	741-0155		Chain Case Half Ass'y.—L.H.
5	713-0316		Sprocket and Hub Ass'y.	23	721-0156		Bearing
6	750-0351		Bearing Inner Axle	24	721-0157		Gasket
7	741-0228		Sleeve-Brg. 5/8" I.D. x 3/4" O.D. x 1.50	25	731-0486		Seal
8	710-0369		Hex Bolt 3/8-24 x 2.50" Lg.*	26	05034A	N	Dust Cup
9	712-0116		Hex Ins. L-Nut 3/8-24 Thd.	27	710-0195		Bearing Housing
10	736-0169		L-Wash. 3/8" I.D.*	28	712-0138		Hex Bolt 1/4-28 x 5/8" Lg.
11	736-0219		Bell-Wash. .41" I.D. x 1.13" O.D. x .03	29	736-0329		Hex Nut 1/4-28 Thd.
12	713-0330		Sprocket & Hub Ass'y. 9T-22T	30	710-0599		L-Wash. 1/4" I.D.*
13	713-0326		#420 Chain 1/2 Pitch x 28 Links Endless	31	710-0378		Hex Wash. S-Tap Scr. 1/4-20 x .50" Lg.
14	784-0126A		Wheel Shaft Ass'y.	32	712-0158		Hex Bolt 5/16-18 x 2.5" Lg.
15	741-0227		Flange Bearing	33	736-0159		Hex Cent. L-Nut 5/16-18 Thd.
16	736-0265		Fl-Wash. .88" I.D. x 1.5" O.D. x .03	34	750-0917		Fl-Wash. 5/16" I.D.
17	750-0354A		Spacer 7/8" I.D. x 13/4" O.D. x .68" Lg.	35	750-0916		Spacer .64" I.D. x 1.76" Lg.
18	736-0265		Fl-Wash. .88" I.D. x 1.50" O.D. x .03	—	737-0223		Spacer .64" I.D. x .45" Lg.
				—	686-0069	N	Grease—#00EP (16 oz. Bottle-10 oz. Req'd.)
							Wheel Chain Case Comp.