

Service Kit

753-0840

CODE: T-144

DATE: October 7, 1998

SUBJ: Speed selector assembly

Install Service Kit 753-0840 when replacing speed selector lever assembly part number 16906.

When installing replacement speed selector lever assembly it will be necessary to drill an additional hole in the frame for proper installation. Location of the hole to be drilled can be determined by installing the speed selector in the frame and secure with hardware provided in kit. Install one shoulder bolt, washer and nut in the front portion of the selector bracket (see Diagram) and secure. Mark the location of the rear mounting hole and drill with 5/16" drill bit. Install remaining shoulder bolt, lock washer, and nut and secure.

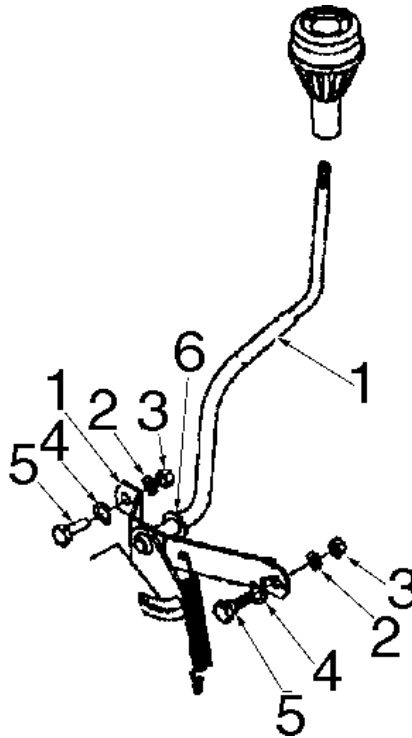

Service Kit 753-0840 Consists of:

Ref. No.	Part No.	Description	Qty.
1	647-0011	Speed selector lever assembly	1
2	736-0119	Lock Washer	2
3	712-3010	Hex Nut	2
4	736-0141	Spring Washer	2
5	738-0296	Shoulder bolt	2
6	736-0192	Flat Washer	1