



Service Kit 753-0913

CODE: ST-170

DATE: October 19, 2001

SUBJECT: OEM-190-823 Snow Thrower Attachment PTO Belt Guide

MODELS 600 and 800 Series AutoDrive

AFFECTED: Tractors with 42" Dual Belt Decks and Manual PTO.

This Service Kit is applicable to OEM-190-823 units with a date code of #F011G##### through #G311G#####.

This Service Kit is to be used to alleviate interference of the PTO Engagement Plate's brake cable attach pin with the PTO belt upon engaging the PTO. Only manual PTO tractors with the PTO Engagement Plate, P/N 683-0450, are affected. See **Pre-Installation Preparation** below. This kit should be installed before the Snow Thrower's Undercarriage Assembly is installed onto the tractor.

Typical Installation Time: 30 Minutes

Service Kit Contents (See FIGURE 1)

REF. NO.	PART NUMBER	QTY	DESCRIPTION
1	712-0431	1	Nut: FlgLk:3/8-16:GRF: Top Lock
2	650-0040	1	Spacer Assembly: Idler
3	714-0145	1	Pin: Internal Cotter

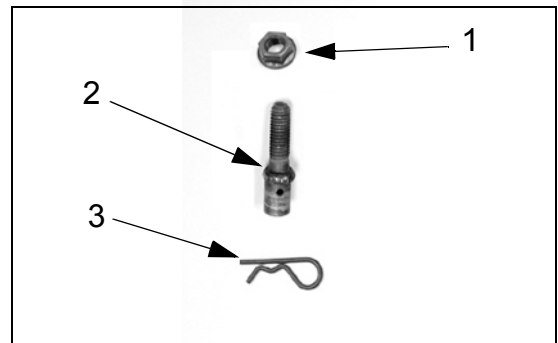

FIGURE 1

Pre-Installation Preparation:

1. The Undercarriage Assembly may have been assembled with an Idler Assembly consisting of a pulley, idler plate, extension spring and shoulder spacer installed adjacent to the large pulley. See FIGURE 2.

NOTE: This Idler Assembly is only required if your tractor was manufactured AFTER September 1, 2001. See OEM-190-823 Operator's Manual Addendum.

2. If Idler Assembly is present, remove the Idler Assembly, tension spring and shoulder spacer. The Idler Assembly must be removed in order to provide clearance to properly install the Undercarriage Assembly to the tractor. Retain all removed Idler Assembly components for future use. See FIGURE 3.

3. Ensure that the hex lock nut removed to uninstall the Idler Assembly and shoulder spacer, is reinstalled and tightened securely. See FIGURE 3.

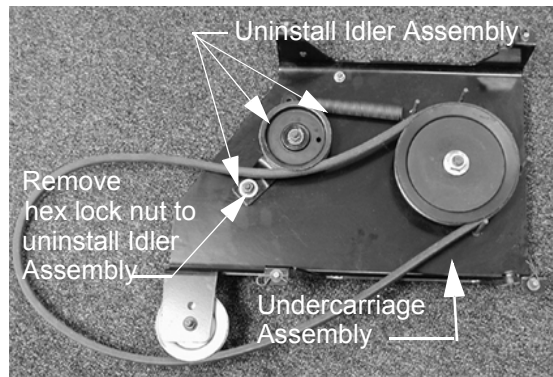

FIGURE 2

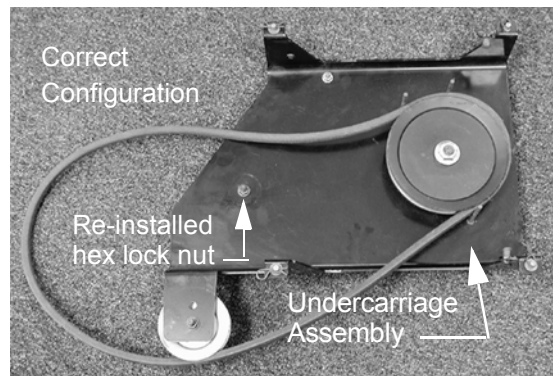

FIGURE 3

Belt Guide Pulley Installation Procedure:

4. Remove the idler pulley, P/N 756-0627B, from the Idler Assembly removed in Step 2. If the Idler Assembly was not installed on the undercarriage assembly see OEM-190-823 Operator's Manual Addendum Section 2. See FIGURE 4.

5. On the tractor, locate the PTO Idler Bracket, P/N 683-0450. Refer to your Tractor's Owner's Manual figures. See FIGURE 5.

NOTE: Mower deck and belt must be removed to install snow thrower.

6. Install the Idler Spacer Assembly, Reference Item #2, onto the Brake Cable Attach Pin of the PTO Idler Bracket. (Remove brake cable, if not already removed, and retain. It is not required for snow thrower operation.) Rotate the Spacer Assembly to line up holes with hole through the Brake Cable Attach Pin. Insert Internal Cotter Pin, Reference Item 3, through holes. See FIGURE 6.

7. Install pulley, P/N 756-0627B, onto the threaded section of the Idler Spacer Assembly, Reference Item 2. NOTE: Ensure the pulley is installed so that the raised spacer inner race of the pulley is facing away from the PTO Idler Bracket. See FIGURE 7.

8. Secure the pulley onto the Spacer Assembly with the Hex Lock Nut, Reference Item 1, Tighten securely. See FIGURE 7.

9. Refer to your OEM-190-823 Owner's Manual for selection of the proper upper drive belt and installation.

10. When installing the upper drive belt, route the belt around the newly installed belt guide pulley so that the back of the belt is against the pulley.



FIGURE 4

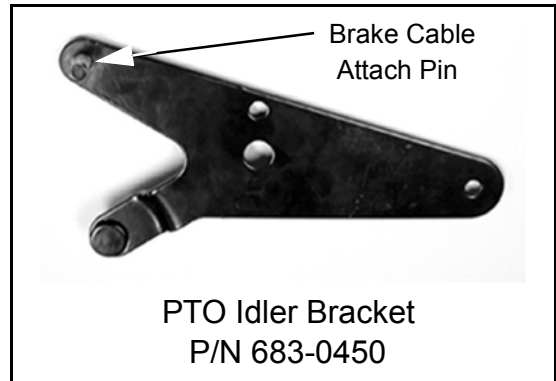

FIGURE 5



FIGURE 6

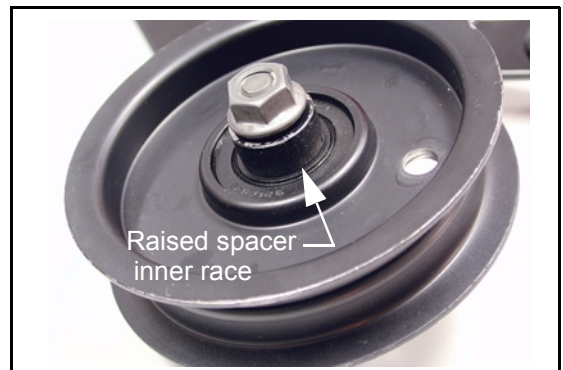

FIGURE 7