

# INSTALLATION MANUAL

## 30-inch Mulch Kit — 19A30012OEM

Model 19A30012OEM mulch kit is designed for use with select 30-inch single-blade cutting decks. Refer to your lawn tractor's Operator's Manual to assure compatibility.

### Carton Contents

Before beginning installation, remove all parts from the carton to make sure everything is present. Carton contents are listed below. Part numbers are shown in parentheses.

- One 30" Deck Mulch Plug Assembly (631-04632)

### Removing the Discharge Chute

1. Remove the wing knob that secures the discharge chute in place.
2. Shift the discharge chute to the right to unlock it.
3. Remove the discharge chute from the deck discharge opening by lifting it off the deck. See Figure 1-1.

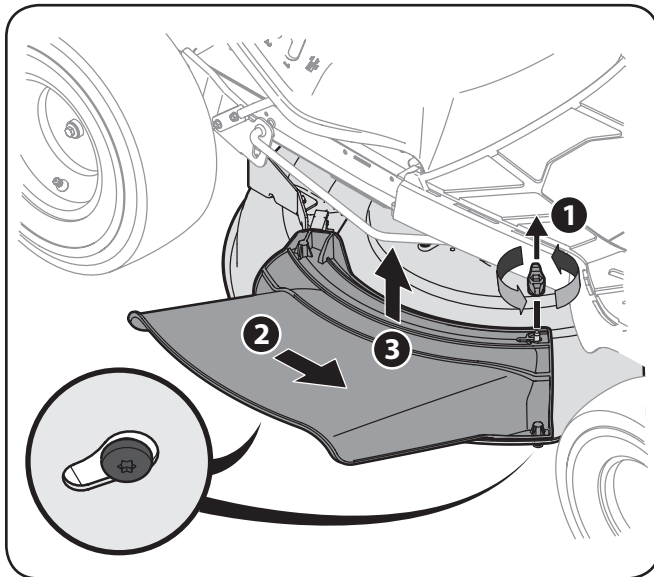

Figure 1-1

### Installing the Mulch Plug

1. Install the mulch plug into the deck discharge opening by positioning the shoulder bolts found on the base of the plug into the holes on the deck. The stud on the deck surface will fit through the hole on the upper portion of the mulch plug. See Figure 1-2.

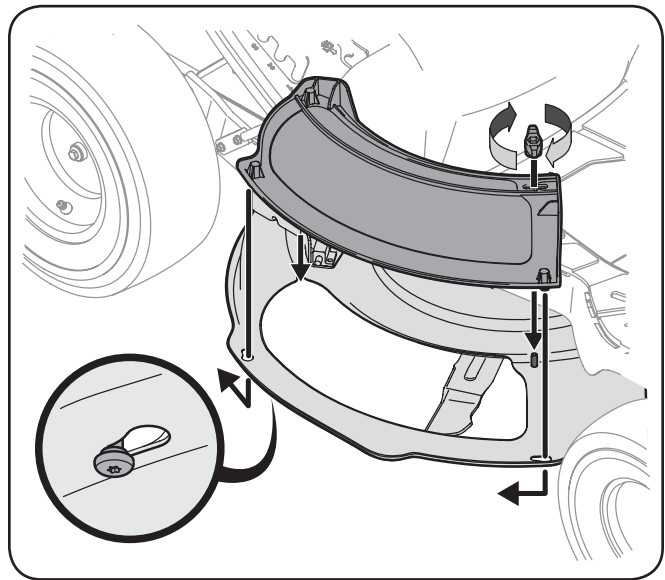

Figure 1-2

2. Shift the mulch plug to the left to lock it in place.
3. Secure the mulch plug by tightening the wing knob on the stud.

MTD LLC, P.O. BOX 361131 CLEVELAND, OHIO 44136-0019