

**MODEL: HACM203P/5M**  
**5 hp 20" CUT CONVERTIBLE 3 SPEED SELF-PROPELLED MULCHING MOWER**  
Grass Catcher Model: APMM-GC  
See page 162

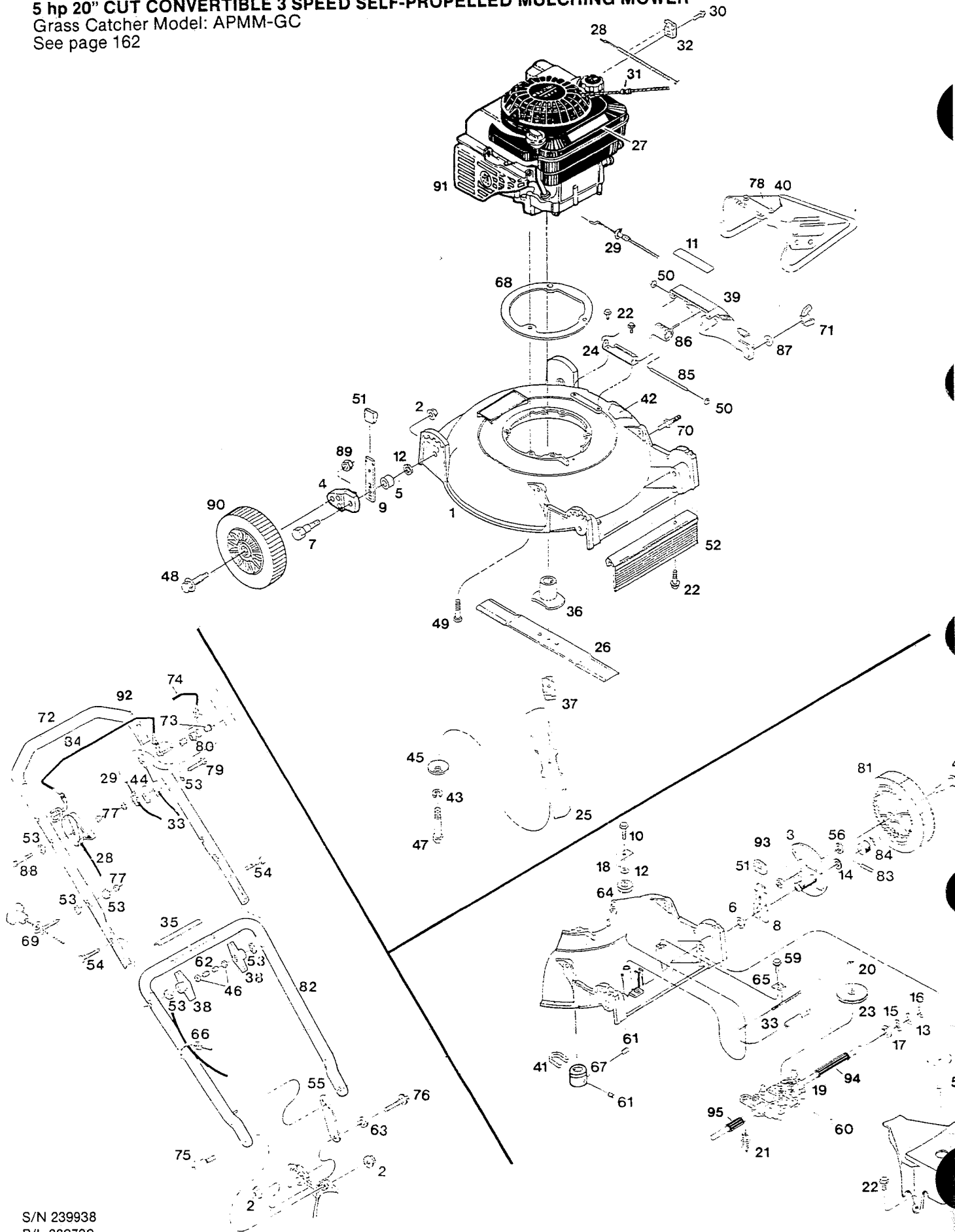

S/N 239938  
P/L 082730  
O/M 082719  
E/M 082690

**MODEL: HACM203P/5M**  
**5 hp 20" CUT CONVERTIBLE 3 SPEED SELF-PROPELLED MULCHING MOWER**  
 Grass Catcher Model: APMM-GC  
 See page 162

INDEX NO.	PART NO.	DESCRIPTION	INDEX NO.	PART NO.	DESCRIPTION
1	023780	Deck - 20"	48	382889	Bolt - wheel
2	159236	Nut - 5/16-18 flg. lock	49	382881	Bolt - 3/8-16 x 1-3/4" HHCS Gr. 5
3	095300	Drive wheel support ass'y	50	452128	Nut - 1/4 push-on
4	031455	Wheel arm - blk	51	579717	Plastic tip - height adjuster
5	581274	Spacer - front hgt. adj.	52	579730	Trailing shield - plastic
6	581477	Spacer - rear hgt. adj.	53	150201	Washer - 5/16 curved
7	581490	Bolt - height adjuster	54	151936	Bolt - handle
8	588449	Setting lever assy R.H. rear	55	095176	Handle support
	588450	Setting lever assy L.H. rear	56	581584	Washer - 3/8" flat
	588451	Setting lever assy. R.H. front	57	115394	Shift knob - plastic
9	588452	Setting lever assy. L.H. front	58	115386	Drive cover 3 spd.
10	154294	Screw - 1/4-20 x 1 hex tap	59	158089	Screw - 1/4-20 x 1/2" hex hd. tap
11	799505	Decal - danger mulch cover	60	583436	Key - transmission pulley
12	715185	Washer - 5/16" flat	61	583085	Set screw 1/4-20 x 3/8"
13	579094	Washer - shim	62	110064	Cap - bolt end, plastic
14	580632	Washer - 9/16" flat	63	583302	Washer - 5/16" wave
15	581005	Washer - 9/16" flat	64	086702	Pulley - 1/4" dia.
16	583308	Washer - 9/16" wave	65	586626	Clamp - drive cable
17	583355	E-ring	66	587059	Cable tie
18	096305	Retainer bracket	67	095218	Drive pulley
19	176792	Transmission - 3 spd.	68	588984	Engine ring
20	589368	Nut - 10mm lock	69	152371	Eyebolt - 1/4-20
21	589468	Spring - compression	70	587992	Stud - 1/4-20 x 3/4"
22	583021	Screw - 1/4-20 x 3/4" hex hd. tap	71	587998	Wing nut - 1/4-20 nylon insert
23	589376	Pulley - transmission	72	073411	Handle - upper
24	095003	Bracket - hinge	73	588463	Bushing - drive bail
25	031420	Blade - 20"	74	588474	Sleeve - drive bail
26	031421	Blade - recut 20"	75	588491	Bolt - handle mtg.
27	009415	Decal - blade warning	76	588499	Bolt - handle supt.
28	053088	Control - throttle w/cable	77	715037	Nut - 1/4-20 hex keps
29	053048	Cable - engine/blade control	78	144063	Decal - DANGER
30	166640	Screw - #10-16 x 5/8" tap	79	153874	Bolt - hex - 1/4-20 x 2-1/4
31	152074	Rope stop	80	095202	Bail - ground drive control
32	157552	Cable clamp	81	588465	Wheel - 8" power propelled
33	053050	Cable - traction control	82	588807	Handle - lower
34	095200	Bail - engine/blade control	83	589363	Drive pin
35	799599	Decal - starting instructions	84	589366	Pinion R.H. 3 spd.
36	095217	Adapter - blade with key		589365	Pinion L.H. 3 spd.
37	094911	Spacer - blade	85	604081	Rod hinge
38	113589	Wing nut - plastic	86	604082	Spring - mulch cover
39	115329	Cover - mulch 20"	87	615690	Washer - 1/4" flat
40	115360	Chute deflector assembly	88	450379	Bolt - 1/4-20 x 1-3/4
41	178855	V-belt	89	715391	Nut - 3/8-16 hex
42	143115	Decal - CPSC danger	90	588437	Wheel - 8"
43	156919	Washer - 3/8" lock H.D.	91	*	Engine
44	115337	Spacer - cable mount	92	794412	Decal - engage/disengage
45	164681	Washer - 3/8" conical	93	715524	Nut - hex 3/8-16 cntrlock jam
46	310045	Nut - 5/16-18 hex	94	115463	Cover - drive shaft 3-7/8
47	382846	Bolt - 3/8-24 x 3-1/2" HHCS Gr. 8	95	115464	Cover - drive shaft 1-3/4

\* Contact engine manufacturer's authorized service dealer for parts and warranty.