

**MODEL WRRBQSP21K'**  
**21" SELF-PROPELLED REAR BAGGING MOWER**  
 Grass Catcher Model Included - see p.13

SEE GRASS CATCHER  
 ASSEMBLY INSTRUCTIONS  
 FOR CATCHER PARTS

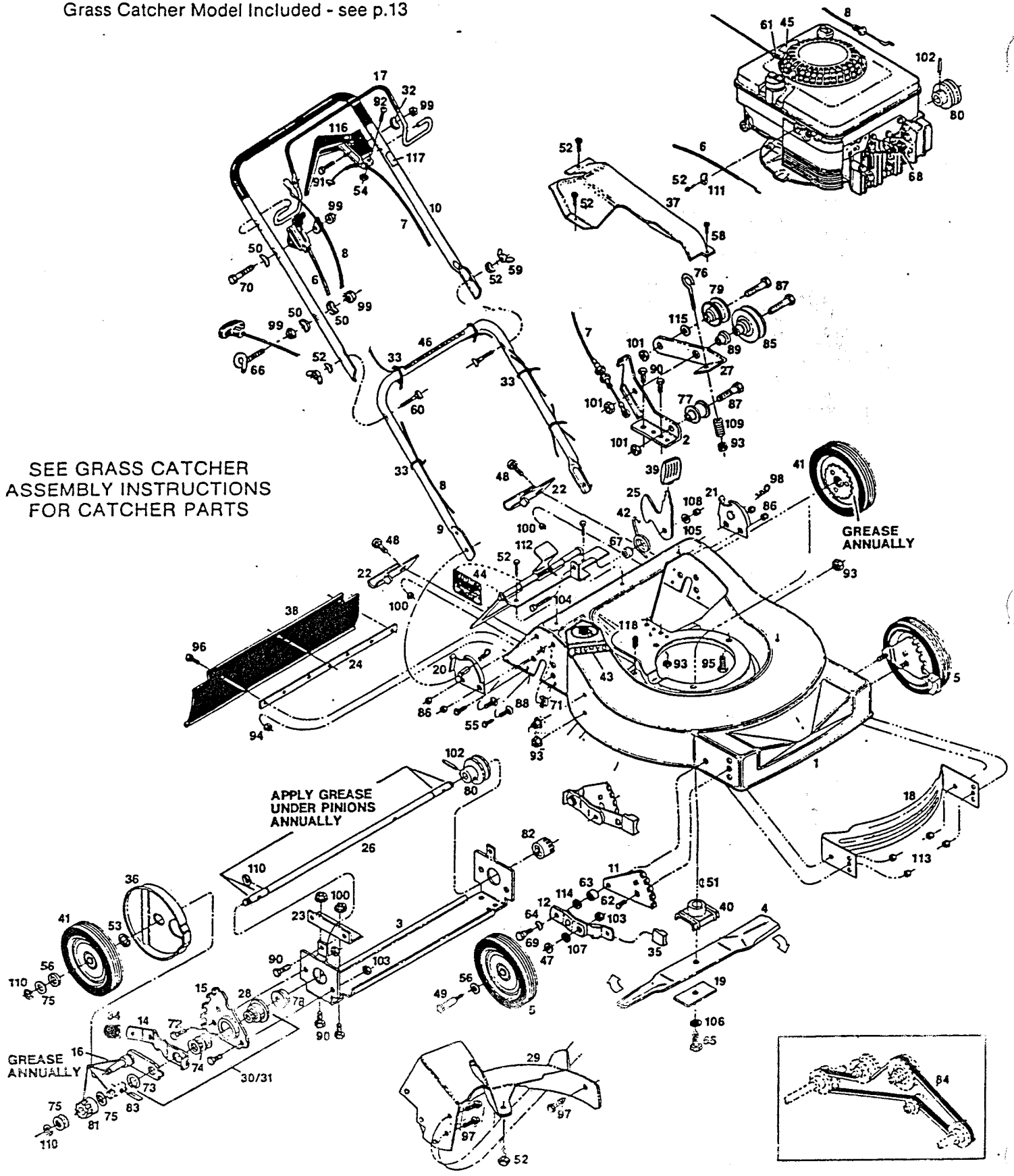

**MODEL WRRBQSP21K**  
**21" SELF-PROPELLED REAR BAGGING ROTARY MOWER**  
 Grass Catcher Model Included - see p.13

Index No.	Part No.	Description	Index No.	Part No.	Description
1	018606	Deck	60	151928	Curved head bolt 5/16-18 x 1.75
2	085928	Bracket - idler mount	61	152074	Rope stop
3	024174	Drive support bracket	62	152405	Bolt - carriage 3/8 - 16 x 3/4
4	030338	Blade 21" offset	63	156182	Washer - plastic
5	041848	Wheel 8" x 1.75 front	64	152421	Washer - spring
6	052027	Throttle control w/cable	65	157255	Bolt - blade
7	050955	Control—ground drive w/cable	66	152371	Eyebolt - Rope guide
8	052001	Cable—engine/blade control	67	152637	Spacer - bagger latch
9	071449	Handle - lower	68	110833	Spark Plug Cover
10	072256	Handle - upper	69	156125	Bolt - shoulder
11	091249	Back plate - front adjuster	70	153874	Bolt - 1/4-20 x 2 1/4
12	085019	Wheel Arm Assembly	71	154393	Nut - Snap in 1/4 - 20
13	714170	Decal-Model Number	72	153817	Bolt - hex head 3/8-16 x 1/2
14	090746	Setting lever - rear adjuster	73	153841	Snapping 3/8
15	090761	Back plate - rear adjuster	74	153858	Spring washer 3/8
16	090910	Wheel lever - rear LH	75	152553	Thrust washer 1/2" I.D.
	090694	Wheel lever - rear RH	76	153908	Bolt - Hook
17	109124	Bail - engine/blade control	77	170456	Pulley - 3/4" bore
18	105825	Baffle - front	78	170464	Bearing - flange ball
19	106005	Blade washer	79	170530	Pulley - ext hub 3/8" - bore
20	097162	Handle Bracket - RH	80	171421	Pulley - drive 1/2" bore
21	097170	Handle bracket - LH	81	170993	Pinion - ratchet RH
22	109546	Catcher hook	82	170985	Pinion - ratchet LH
23	107128	Drive support mtg. brkt.	83	170811	Drive pawl
24	109496	Backing strip	84	170829	V-belt
25	108324	Latch - rear bagger	85	170878	Idler - pulley
26	108357	Drive shaft	86	310151	Nut - nylon insert - 5/16 - 18
27	107193	Idler arm	87	312322	Bolt - hex hd 3/8-16 x 1.75
28	109082	Stepped sleeve	88	450346	Bolt hex hd 5/16-18 x 3/4
29	085100	Baffle Assembly	89	326348	Shouldered spacer
30	128926	Height Adjuster Assembly rear LH	90	449587	Bolt hex hd 1/4-20 x 3/8
31	128918	Height Adjuster Assembly rear RH	91	450072	Bolt - Hex 1/4-20 x 1 1/2
32	461004	Washer - Curved 1 - 1/4 O.D.	92	459065	Screw - Pan Head #8-32-3/8
33	110379	Cable tie	93	451419	Nut - TL flange 1/4-20
34	110510	Plastic tip - rear adjuster	94	452318	Nut - hex nylon insert #10-24
35	112540	Plastic tip - front adjuster	95	457168	Bolt - thread form 3/8-16 x 3/8
36	112037	Dust cover - rear wheel	96	458687	Bolt - hex #10-24 x 1/2
37	113662	Belt cover	97	156851	Bolt - 1/4-20 x 3/8 SHVD HD
38	111633	Vinyl trailing shield	98	715011	Hairpin Cotter
39	111724	Knob - catcher latch	99	715037	Nut - keps 1/4 - 20
40	126466	Blade adapter	100	715078	Nut - flange whiz 1/4-20
41	041954	Wheel - rear, w/gear	101	715086	Locknut - hex - 3/8 - 16
42	133371	Torsion spring - catcher latch	102	715193	Roll pin 3/16 x 1
43	143115	Decal - Danger	103	715524	Nut - hex 3/8 - 16 Jam
44	795039	Decal - door warning	104	715292	Bolt hex head 1/4 - 20 x 1
45	001206	Decal - blade warning	105	715300	Washer - flat 1/4"
46	144899	Decal - starting instructions	106	156919	Lockwasher 3/8 HD Split
47	715607	Washer - 3/8 Belleville	107	715417	Washer - 3/8
48	150011	Carriage bolt - 1/4-20 x 3/8	108	715508	Nut top lock - 1/4 - 20
49	150730	Wheel bolt - front	109	776468	Spring - idler cable
50	150201	Curved washer - 3/8	110	789883	E-ring
51	150276	Woodruff key #6	111	157552	Cable clamp
52	150623	Bolt - slotted hex #10 x 3/8	112	013706	Door assembly
53	790451	Ring - retainer	113	156406	Nut 3/8 - 16 Flange Lock
54	151894	Nut Hex #8-32 Nylock	114	156877	Washer Hardened
55	153601	Self tan screw 1/4-20 x 3/4	115	150771	Washer - Flat
56	151449	Washer - wheel retaining	116	111575	Lever-Ground Drive Control
57	151613	Bolt - hex head semis #10-32 x 3/8	117	794412	Decal-Drive Control Instructions
58	151621	Screw - self drilling #6-20 x 1/2	118	111856	Cap-Bolt Plastic
59	150235	Wing nut 5/16-18			

- This parts list covers several different mower models; not all of the parts listed may be used on the particular model you are working with.
- When servicing use only Genuine Factory Replacement Parts (OEM) that are specifically designed for the particular model that you are working with.
- Parts are right or left hand as viewed from the operator's position.
- Model specifications are subject to change without prior notice.
- Do not operate the mower unless all parts are attached and in good working order.
- Lawn mower deck and/or other painted parts differing in color may be substituted without notice.